

UHF31EZ-L600

UHF Plug Crimp For JBY600,LMR600

50Ω

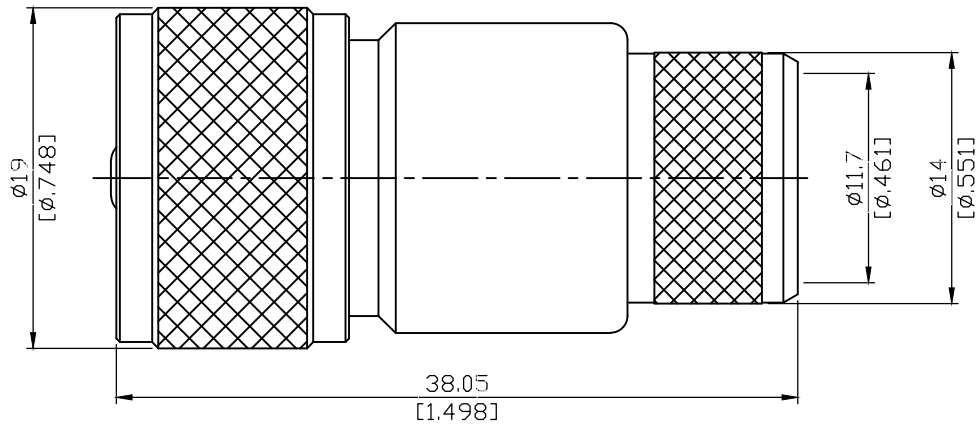

Parts	Material	Plating (Micro-inch)
Ferrule	Copper	Tin-Zinc-Copper-Alloy 100 Over Copper 50
Retainer Ring	Brass	Tin-Zinc-Copper-Alloy 100 Over Copper 50
Contact Pin	P.Bronze	Gold 4 Over Nickel-Phosphorus Alloy 80 Over Copper 20
Insulator	Teflon	
Body	Brass	Tin-Zinc-Copper-Alloy 100 Over Copper 50
Coupling Nut	Brass	Tin-Zinc-Copper-Alloy 100 Over Copper 50

Suitable Cables: JBY600, LMR600

This part number complies with RoHS.

Notice: JYEBAO reserves the right to make modifications demand appropriate.

JYE BAO CO., LTD.

CABLE ASSEMBLY INSTRUCTION

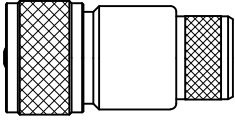
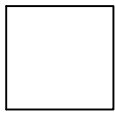
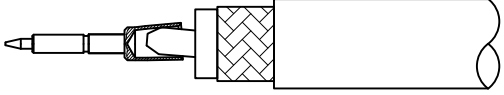
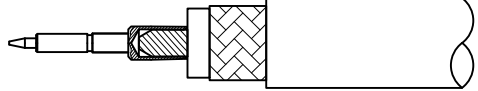
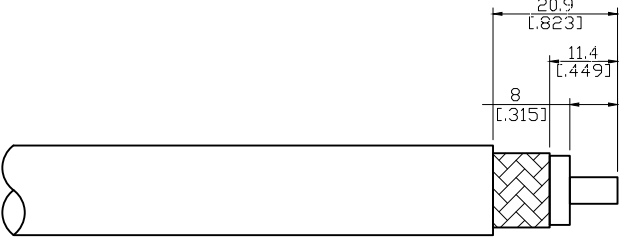
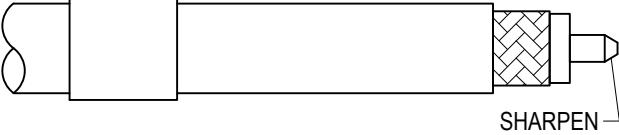
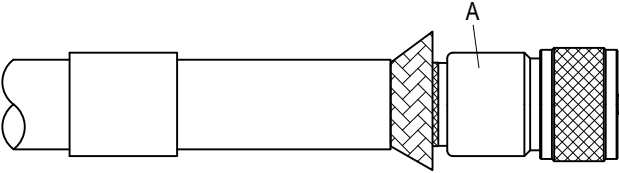
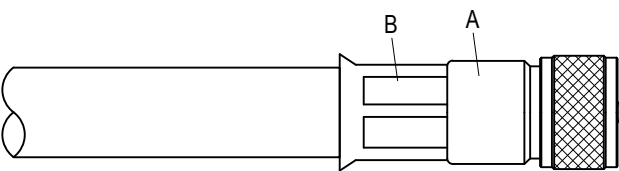
UHF31EZ-L600	DATE	2016/07/20	REV	—
A	B	NOTE: THE STRIPPED CABLE AND POINTED CENTER CONDUCTOR MUST BE STRAIGHT (180°), IF NOT LEAVES WILL BREAK EASILY.		
		NG		
BODY	FERRULE	OK		

DIAGRAM	ASSEMBLY INSTRUCTION
	Step 1: STRIP AS SHOWN.
	Step 2: SHARPEN CENTER CONDUCTOR TIP. Step 3: SLIDE FERRULE " B " OVER CABLE. NOTE: THE STRIPPED CABLE AND POINTED CENTER CONDUCTOR MUST BE STRAIGHT (180°), IF NOT LEAVES WILL BREAK EASILY.
	Step 4: LOOSEN BRAIDING AND SLIDE CONNECTOR " A " IN PLACE.
	Step 5: SLIDE FERRULE " B " TOWARDS THE CONNECTOR " A " AND CRIMP. (USE 15.5mm/0.610inch HEX SECTION OF INSERT-F)

This part number complies with RoHS.

Notice: JYEBAO reserves the right to make modifications deemed appropriate.

APPROVED	CHECKED	DRAWING
		<i>Albert</i>