

FME (Female) Straight Cable Jack

FME2C50-R240A/H3

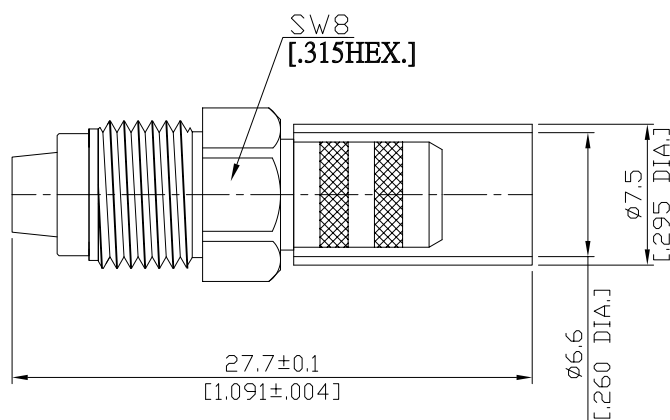

All dimensions are in mm [inch]

Tolerances according to DIN ISO 2768-mH

**Interface**

According to N/A

**Electrical Data**

Impedance 50 Ω

Frequency DC to 2.5 GHz

- Limitations are possible due to the used cable type and manufacturing process -

**Mechanical Data**

Coupling mechanisms Screw-lock  
Centre contact Soldered or Crimped  
Cable entry Crimped

**Environmental Data**

Temperature range -65°C to +165°C  
RoHS compliant

**Material And Plating**

Connector parts	Material	Plating
Centre contact	Phosphor Bronze	Gold plating(Nickel underplated)
Body	Brass	Nickel
Insulator	PTFE	
Crimp ferrule	Brass	Nickel

**Suitable Cables**

LMR 240, RNL-240, BELDEN 7808A, BELDEN 9258, BELDEN H155

**Packing**

Single or 100

FME (Female) Straight Cable Jack

FME2C50-R240A/H3

Recommended Cable Stripping Dimensions

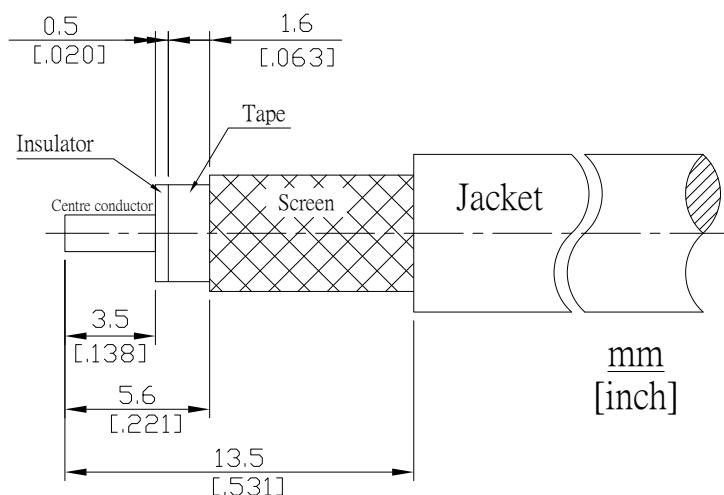

Crimp Dimensions [HEX]

Crimp ferrule	6.48mm [.255 inch]
Centre contact	1.73mm [.068 inch]